

Waveguide Terminations

1.7-40 GHz

Rectangular Waveguide Terminations

- Low and Medium Power Handling Versions
- Standard Waveguide Sizes



Specifications

Low Power, 1.7 to 40 GHz

FREQUENCY RANGE (GHz)	MODEL	WAVEGUIDE SIZE	FLANGE TYPE	FLANGE EQUIVALENT	VSWR (max.)	POWER	
						AVERAGE (W)	PEAK (kW)
1.70 - 2.60	305L	WR430	CPRF	UG-1711/U	1.04	15.0	15.0
2.60 - 3.95	306L	WR284	Cover	UG-584/U	1.04	10.0	10.0
3.30 - 4.90	307L	WR229	CPRF	UG-1727/U	1.04	10.0	10.0
3.95 - 5.85	308L	WR187	Cover	UG-407/U	1.04	8.0	8.0
4.90 - 7.05	309L	WR159	CPRF	UG-1731/U	1.04	7.0	7.0
5.85 - 8.20	310L	WR137	Cover	UG-1733/U	1.04	6.0	6.0
7.05 - 10.0	311L	WR112	Cover	UG-138/U	1.04	4.0	4.0
7.00 - 11.0	312L	WR102	Cover	MIL-F-3922/70-014	1.04	3.0	3.0
8.20 - 12.4	313L	WR90	Cover	UG-135/U	1.04	4.0	7.0
10.0 - 15.0	314L	WR75	Cover	MIL-F-3922/70-017	1.04	2.0	2.0
12.4 - 18.0	315L	WR62	Cover	UG-1665/U	1.04	1.5	1.5
15.0 - 22.0	316L	WR51	Cover	MIL-F-3922/70-024	1.04	1.0	1.0
18.0 - 26.5	317L	WR42	Cover	UG-597/U	1.04	0.5	0.5
22.0 - 33.0	318L	WR34	Cover	UG-1530/U	1.04	0.5	0.5
26.5 - 40.0	319L	WR28	Cover	UG-599/U	1.04	0.5	0.5

Waveguide Terminations

Medium Power, 2.6 to 40 GHz

FREQUENCY RANGE (GHz)	MODEL	WAVEGUIDE SIZE	FLANGE TYPE	FLANGE EQUIVALENT	VSWR (max.)	POWER	
						AVERAGE (W)	PEAK (kW)
2.60 - 3.95	306M	WR284	Cover	UG-584/U	1.15	1200	800
3.30 - 4.90	307M	WR229	CPRF	UG-1727/U	1.15	1000	800
3.95 - 5.85	308M	WR187	Cover	UG-407/U	1.15	750	750
4.90 - 7.05	309M	WR159	CPRF	UG-1731/U	1.15	625	625
5.85 - 8.20	310M	WR137	Cover	UG-441/U	1.15	500	400
7.05 - 10.0	311M	WR112	Cover	UG-138/U	1.15	425	400
7.00 - 11.0	312M	WR102	Cover	MIL-F-3922/70-014	1.15	325	300
8.20 - 12.4	313M	WR90	Cover	UG-135/U	1.15	225	225
10.0 - 15.0	314M	WR75	Cover	MIL-F-3922/70-017	1.15	200	200
12.4 - 18.0	315M	WR62	Cover	UG-1665/U	1.15	100	200
15.0 - 22.0	316M	WR51	Cover	MIL-F-3922/70-024	1.15	100	120
18.0 - 26.5	317M	WR42	Cover	UG-597/U	1.15	100	120
22.0 - 33.0	318M	WR34	Cover	UG-1530/U	1.15	75	80
26.5 - 40.0	319M	WR28	Cover	UG-599/U	1.15	75	50

NOTE:

For a complete listing of all band letters and codes in use, refer to Band Designation Table on Page 183.

Outline Drawings

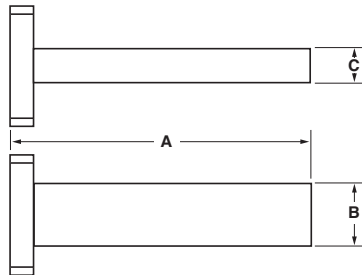
**Low Power**

MODEL	DIMENSIONS (inches)		
	A	B	C
305L	11.00	4.46	2.31
306L	10.80	3.00	1.50
307L	7.50	2.42	1.27
308L	6.30	2.00	1.00
309L	6.00	1.72	0.92
310L	5.50	1.50	0.75
311L	5.00	1.25	0.63
312L	4.00	1.12	0.61
313L	4.00	1.00	0.50
314L	4.00	0.85	0.48
315L	4.00	0.70	0.39
316L	4.00	0.59	0.34
317L	2.50	0.50	0.25
318L	2.50	0.42	0.25
319L	2.00	0.36	0.22

Medium Power

MODEL	DIMENSIONS (inches)		
	A	B	C
306M	11.00	3.00	1.50
307M	9.75	2.42	1.27
308M	8.38	2.00	1.00
309M	8.00	1.72	0.92
310M	8.00	1.50	0.75
311M	7.00	1.25	0.63
312M	6.50	1.12	0.61
313M	5.50	1.00	0.50
314M	4.50	0.85	0.48
315M	3.25	0.70	0.39
316M	3.25	0.59	0.34
317M	3.50	0.50	0.25
318M	3.25	0.42	0.25
319M	4.00	0.36	0.22



Waveguide Flange Data

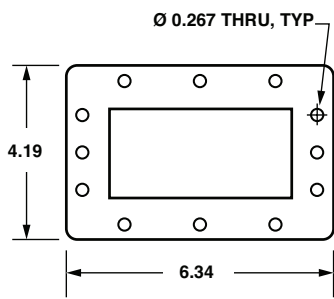

WR430
(UG-1711/U)

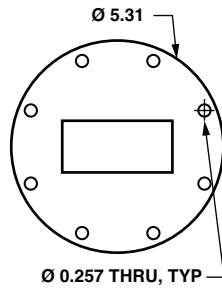

WR284
(UG-584/U)

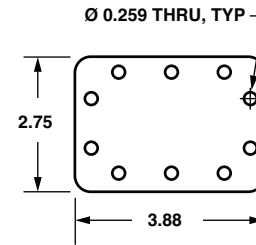

WR229
(UG-1727/U)

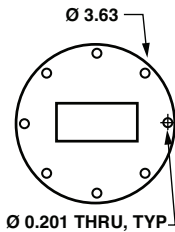

WR187
(UG-407/U)

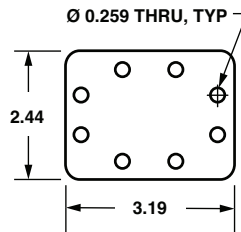

WR159
(UG-1731/U)

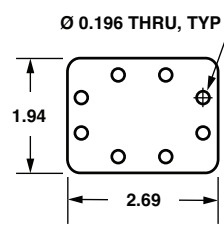

WR137
(UG-1733/U)

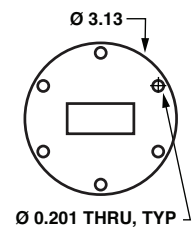

WR137
(UG-441/U)

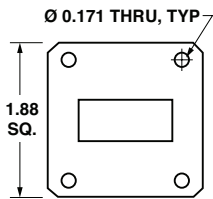

WR112
(UG-138/U)

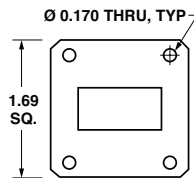

WR102
(MIL-F-3922/70-014)

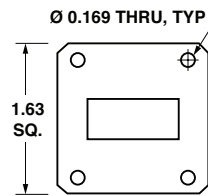

WR90
(UG-135/U)

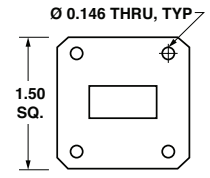

WR75
(MIL-F-3922/70-017)

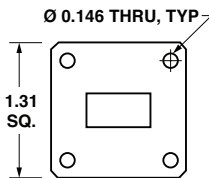

WR62
(UG-1665/U)

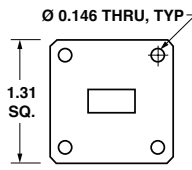

WR51
(MIL-F-3922/70-024)

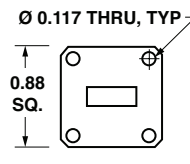

WR42
(UG-597/U)

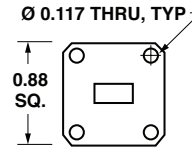

WR34
(UG-1530/U)

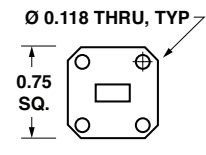

WR28
(UG-599/U)

For a complete listing of all band letters and codes in use, refer to Band Designation Table on page 183.

Dimensions in inches, unless otherwise specified.

