

REVISIONS				
ZONE	LTR	DESCRIPTION	DATE	APPROVED
D		INCORPORATE ECN 36446	08/29/16	<i>schnee</i>

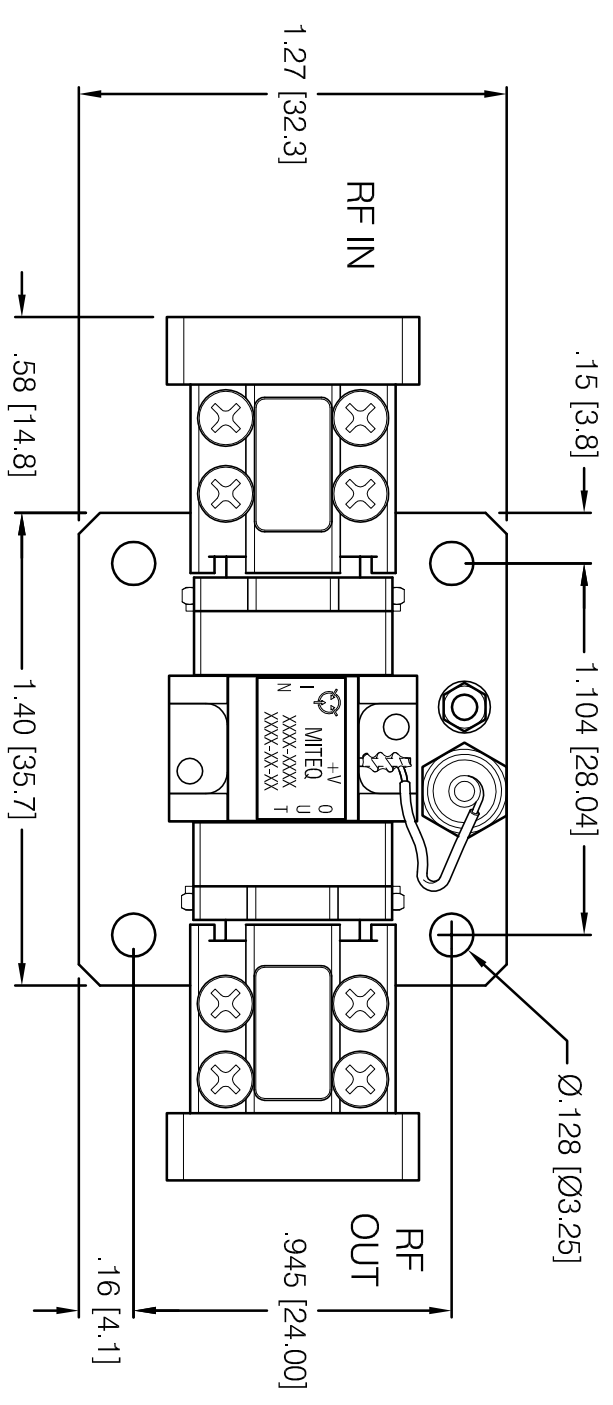

CONFORMS TO WR28
COVER FLANGE WITH Ø.120 [Ø3.05]
THRU HOLES

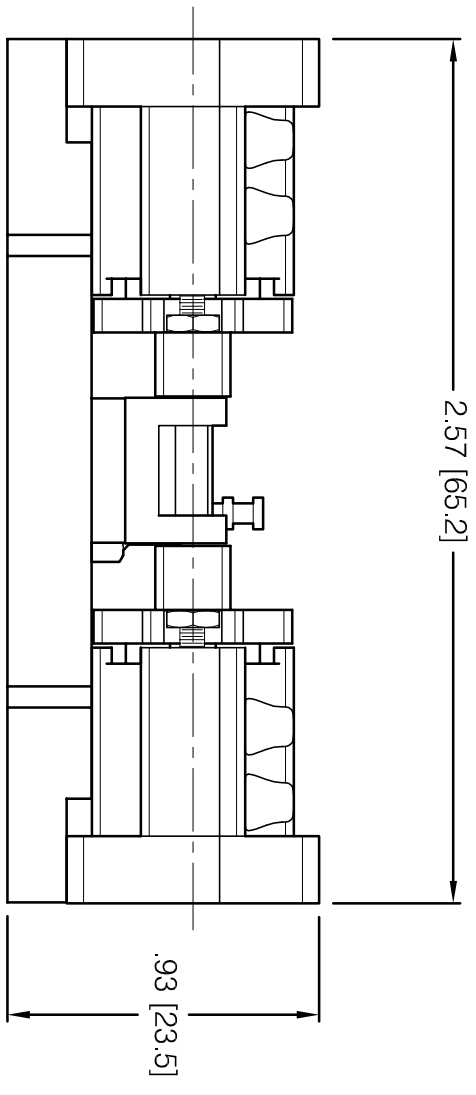
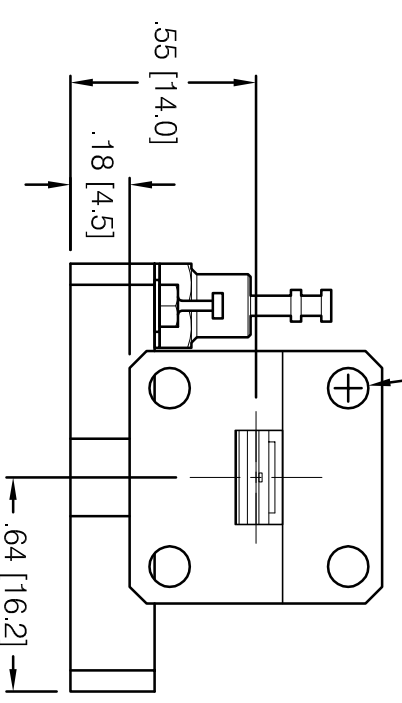

PRINT NOT ON AUTOMATIC DISTRIBUTION VERIFY REVISION PRIOR TO USE

L-3 PROPRIETARY
THIS DOCUMENT CONTAINS INFORMATION WHICH IS PROPRIETARY TO L-3 COMMUNICATIONS CORPORATION. THE CONTENTS SHALL NOT BE DISCLOSED, COPIED, DISTRIBUTED OR USED UNLESS AUTHORIZED BY AN OFFICER OF L-3 COMMUNICATIONS

THIS TECHNICAL DATA IS CONTROLLED UNDER THE EXPORT ADMINISTRATION REGULATIONS (EAR) AND MAY NOT BE EXPORTED TO A FOREIGN PERSON, EITHER IN THE U.S. OR ABROAD, WITHOUT PROPER AUTHORIZATION BY THE U.S. DEPARTMENT OF COMMERCE.

UNLESS OTHERWISE SPECIFIED DIMENSIONS ARE IN INCHES TOLERANCES ON DECIMALS .XX ±.01 .XXX ±.005 ANGLES ±0°30'	PROJECTION	
MATERIAL	PROJ. ENGR.	<i>J. Slinker</i>
FINISH	MFG. ENGR.	
APPLICATION	QA	
NEXT ASSY	USED ON	

DRAWN	<i>E. Wandy</i>	DATE	01/15/97
DRAFT		DESIGN	
APPROVED BY	<i>schnee</i>	DATE	08/29/16
AUTOCAD FILE FORMAT			

OUTLINE DRAWING
JDS AMPLIFIER W/WR28
WAVEGUIDE IN AND OUT

narda **mutler**
453 Woodard Rd. Hightstown, New York 11788

SIZE: C
CODE IDENT. NO.: 33592
SCALE: REF: 45D219

REV. D
SHEET 1 OF 1

132076

