

REVISIONS		DATE	APPROVED
ZONE	LTR	DESCRIPTION	
D		.28 TO .25, NEW FORMAT, ADDED NOTE 2	1/11/2008 <i>Jay Sherrard</i>

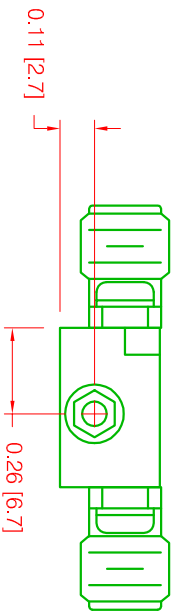

NOTES:  
 1. STANDARD GROUND TERMINAL SHOWN. MAY BE REPLACED BY GROUND LUG AS CUSTOMER OPTION.  
 2. METRIC EQUIVALENTS ARE IN BRACKETS.

QTY REQD		NOMENCLATURE OR DESCRIPTION		SYM/NOTES		PART NO.		CODE IDENT.		ITEM NO.		
-5	-4	-3	-2	-1								
UNLESS OTHERWISE SPECIFIED DIMENSIONS ARE IN INCHES TOLERANCES ON												
DECIMALS .XX±.01 .XXX±.005 ANGLES ±0°30'												
MATERIAL				APPROVED BY				DATE				
FINISH				<i>Jay Sherrard</i>				1/12/2006				
NEXT ASSY				1226842				1/12/2006				
USED ON				1226842				1/12/2006				
APPLICATION				1226842				1/12/2006				

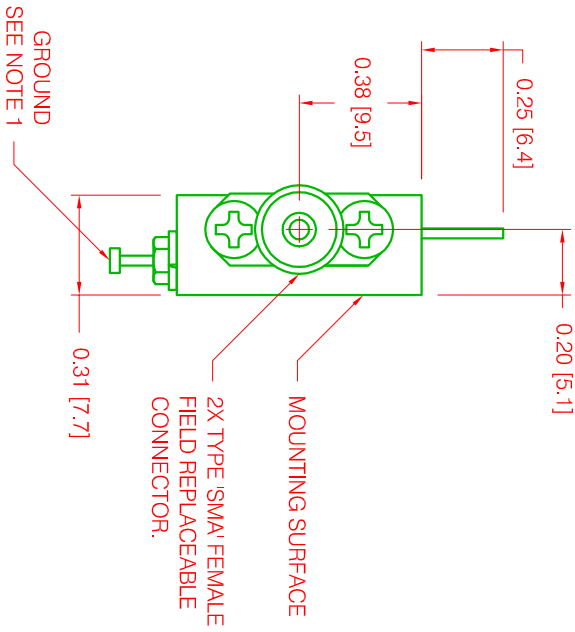
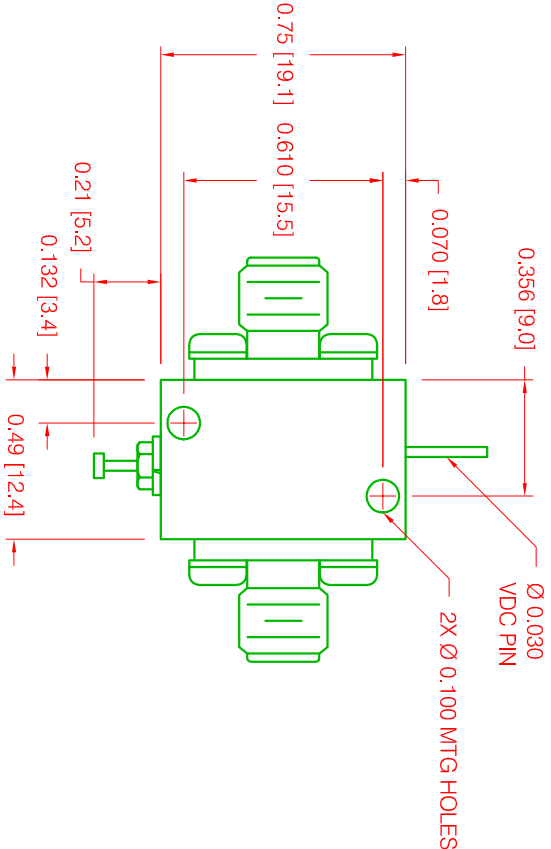
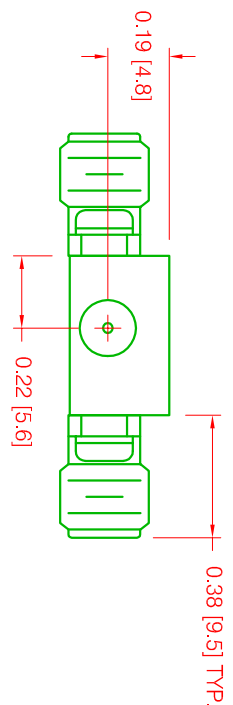

OUTLINE DRAWING  
 ULTRA WIDE BAND AMPLIFIER  
 AMF-SERIES, 2 STAGE

SIZE	CODE IDENT. NO.	REV.
C	33592	D
SCALE	REF	SHEET
	450191	1 OF 1

122686