

# Waveguide Adapters

1.7-18 GHz

## Waveguide to Coaxial Right Angle Adapters, Type N

- Low VSWR
- Low Insertion Loss
- Lightweight



### Specifications

Waveguide to Type N (F), 1.7 to 18 GHz

FREQUENCY RANGE (GHz)	MODEL	WAVEGUIDE SIZE	FLANGE TYPE	FLANGE EQUIVALENT	VSWR (max.)	CW POWER (W)	PEAK POWER (kW)	WEIGHT (max.)	
								lb.	kg.
1.70 - 2.60	617	WR430	CPRF	UG-1711/U	1.25	200	3	1.40	0.64
2.60 - 3.95	618	WR284	Cover	UG-584/U	1.25	200	3	0.80	0.36
3.30 - 4.90	619	WR229	CPRF	UG-1727/U	1.25	200	3	0.45	0.20
3.95 - 5.85	620	WR187	Cover	UG-407/U	1.25	200	3	0.38	0.17
4.90 - 7.05	621	WR159	CPRF	UG-1731/U	1.25	200	3	0.30	0.14
5.85 - 8.20	622	WR137	CPRF	UG-441/U	1.25	200	3	0.25	0.11
7.05 - 10.0	623	WR112	Cover	UG-138/U	1.25	200	3	0.21	0.10
7.00 - 11.0	624	WR102	Cover	MIL-F-3922/70-014	1.25	200	3	0.16	0.07
8.20 - 12.4	625	WR90	Cover	UG-135/U	1.25	150	2	0.15	0.07
10.0 - 15.0	626	WR75	Cover	MIL-F-3922/70-017	1.25	150	2	0.13	0.06
12.4 - 18.0	627	WR62	Cover	UG-1665/U	1.25	150	2	0.12	0.05

#### NOTE:

For a complete listing of all band letters and codes in use, refer to Band Designation Table on Page 183.

### Outline Drawing

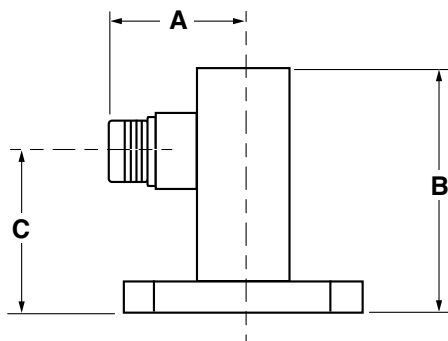

MODEL	DIMENSIONS (inches)		
	A	B	C
617	1.89	4.00	2.30
618	1.49	2.50	1.51
619	1.37	2.25	1.35
620	1.24	2.60	1.90
621	1.20	2.33	1.70
622	1.11	2.00	1.47
623	1.15	1.14	0.68
624	1.18	1.64	1.14
625	1.10	1.00	0.63
626	1.09	1.00	0.63
627	1.08	1.00	0.65

Dimensions in inches, unless otherwise specified.

# Waveguide Flange Data

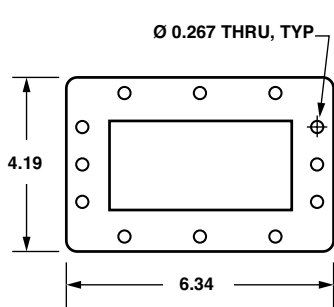

**WR430**  
(UG-1711/U)

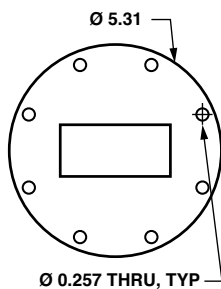

**WR284**  
(UG-584/U)

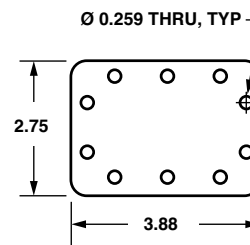

**WR229**  
(UG-1727/U)

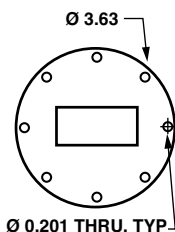

**WR187**  
(UG-407/U)

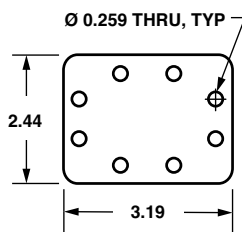

**WR159**  
(UG-1731/U)

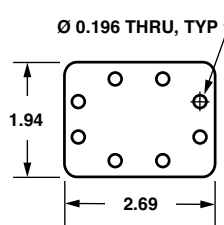

**WR137**  
(UG-1733/U)

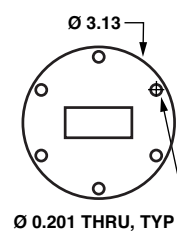

**WR137**  
(UG-441/U)

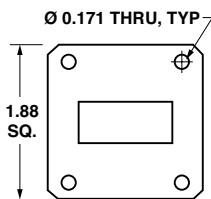

**WR112**  
(UG-138/U)

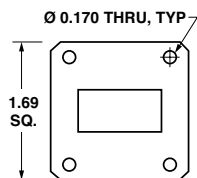

**WR102**  
(MIL-F-3922/70-014)

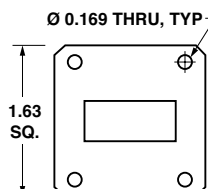

**WR90**  
(UG-135/U)

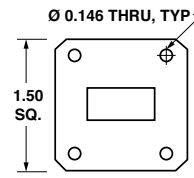

**WR75**  
(MIL-F-3922/70-017)

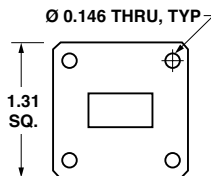

**WR62**  
(UG-1665/U)

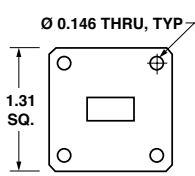

**WR51**  
(MIL-F-3922/70-024)

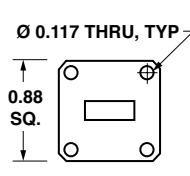

**WR42**  
(UG-597/U)

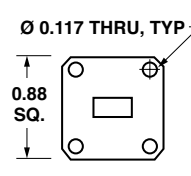

**WR34**  
(UG-1530/U)

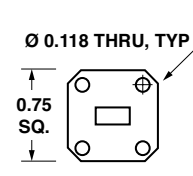

**WR28**  
(UG-599/U)

For a complete listing of all band letters and codes in use, refer to Band Designation Table on page 183.

Dimensions in inches, unless otherwise specified.